

LAYOUTS TO SUIT EVERY FAMILY, EVERY HOLIDAY

V2
 BODY LENGTH: 6.02m
 TOWING LENGTH: 7.87m
 TOWING HEIGHT: 2.91m

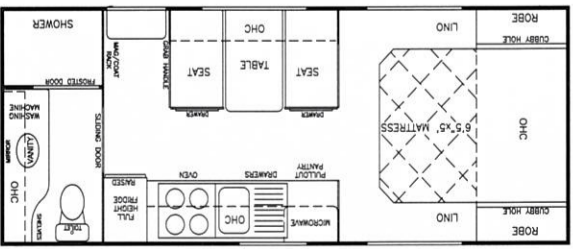

FAMILY V2
 BODY LENGTH: 6.60m
 TOWING LENGTH: 8.45m
 TOWING HEIGHT: 2.96m

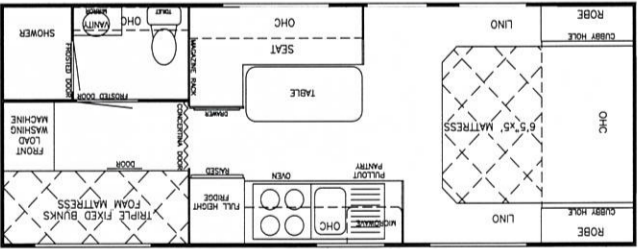

V3.2
 BODY LENGTH: 6.44m
 TOWING LENGTH: 8.29m
 TOWING HEIGHT: 3.02m

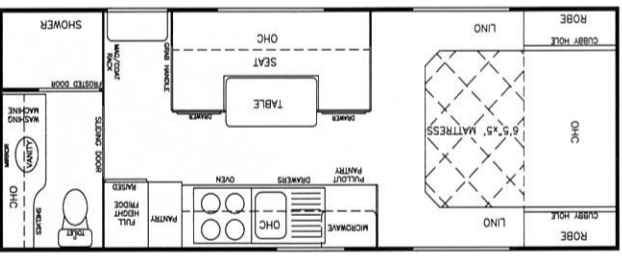

V3.4
 BODY LENGTH: 6.44m
 TOWING LENGTH: 8.29m
 TOWING HEIGHT: 3.02m

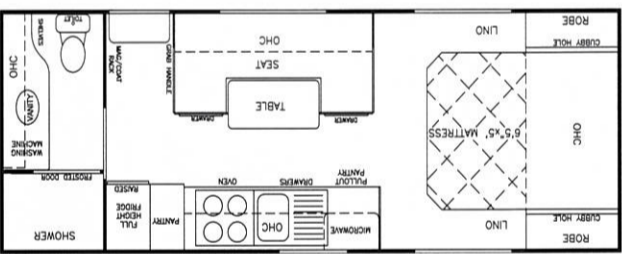

V1
 BODY LENGTH: 5.5m
 TOWING LENGTH: 7.35m
 TOWING HEIGHT: 3.07m

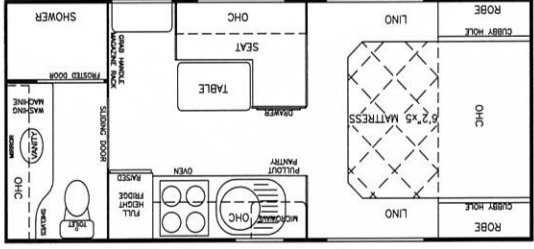

V3.1
 BODY LENGTH: 6.44m
 TOWING LENGTH: 8.29m
 TOWING HEIGHT: 3.02m

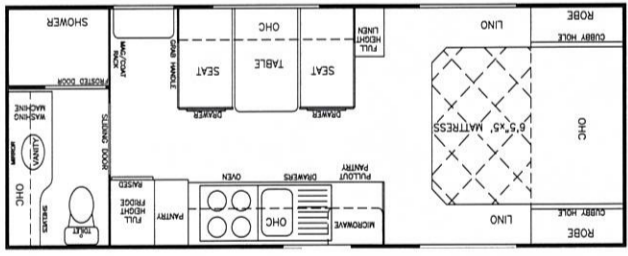

V3.3
 BODY LENGTH: 6.44m
 TOWING LENGTH: 8.29m
 TOWING HEIGHT: 3.02m

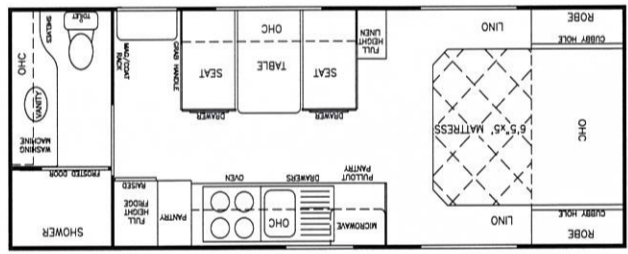

**FAMILY VANS
 AVAILABLE WITH
 2 OR 3 BUNKS**



SPECIFICATIONS

EXTERNAL

- Checkplate lower front
- 3mm composite front panel, rear panel and roof
- White high profile aluminium sides
- 375mm black carbon fibre-look sides
- Fibreglass batt insulation in roof
- Styrofoam insulation in walls
- Radius Camtec triple locking door
- Fully galvanised tunnel boot
- Common waste water outlet
- Tap on A-frame
- 2x9kg gas bottles
- Gas bayonet
- Picnic table
- External grab handle
- Grab handle at entrance
- Double glazed windows
- Galvanised steel protection under water tanks

INTERNAL

- 6'8" internal ceiling height
- Gertfor French-made commercial grade vinyl flooring
- Recessed cooktop
- Oven
- Innerspring mattress
- Flyscreens / blackout windows
- Cubbyholes in robes
- Gloss cupboard doors
- Water tank gauge
- LED lighting throughout

BATHROOM

- Fully moulded fibreglass shower
- Domestic swivel toilet
- Washing machine
- Gas / electric hot water system
- Towel rail and ring

TECHNOLOGY

- Theford 3-way refrigerator
- Reverse cycle air conditioner
- 120W solar panel
- 100 Amp battery
- 25 Amp battery charger
- 24" TV with DVD player
- Bluetooth® radio with ceiling speakers
- External speakers
- External TV point and 12V plug
- Double USB powerpoint
- in lounge
- TV antenna
- Lift-up underbed storage
- 12V pump
- Water filter and tap
- LED light in tunnel boot
- Reverse camera and in-car kit

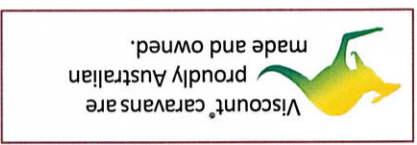

SAFETY

- Smoke alarm
- Fire extinguisher
- Brakesafe breakaway system
- ALKO drop-down corner stabilisers
- Electric brakes to all wheels
- Gas regulator and A-frame tap covers

MODEL	V1	V2	V3	FAMILY V2
MAIN MEMBER	4"	4"	6"	4"
A-FRAME	4"	4"	6"	4"
TYRES	245/R16	205/R15	235/R15	205/R15
WATER TANKS	2 x 62L	1 x 95L+1 x 62L	1 x 95L+1 x 62L	1 x 95L+1 x 62L

